

Courses and distances up French Creek beginning at a Maple

N 21° W 19.5
 N 14° W 40.
 N 7½° W 22.
 N 1° W 83.
 North 26.
 N 9¼° E 14.
 N 12½° E 23.1
 N 21½° E 46
 273 9/10

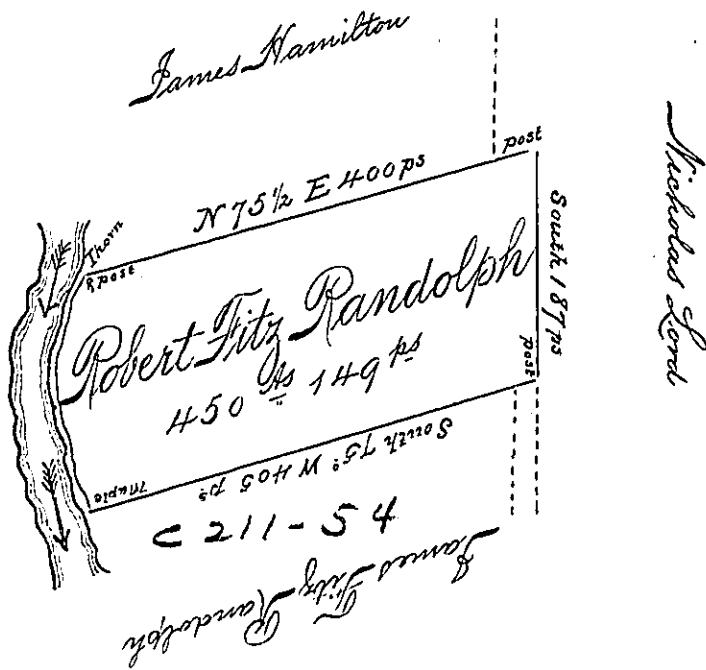

In pursuance of a Warrant for 400 Acres of Land dated the 1st day of December 1801, was surveyed the 8th of June 1802 for Robert Fitz Randolph the above described Tract of Land containing 450 Acres 149 perches and allowance of six per cent for Roads &c Situate in Mead Township Crawford County
 William M. Arthur D^y S^r

To Samuel Cochran Esquire
 Surveyor General

IN TESTIMONY that the above is a copy of the original remaining on file in the Department of Internal Affairs of Pennsylvania, made conformably to an Act of Assembly approved the 16th day of February, 1833, I have hereunto set my Hand and caused the Seal of said Department to be affixed at Harrisburg, this

third day of December 1895.

James W. Fatta
 Secretary of Internal Affairs.